

HiPerFET™ Power MOSFETs

IXFK / IXFN 44 N50
IXFK / IXFN 48 N50

N-Channel Enhancement Mode
Avalanche Rated, High dv/dt, Low t_{rr}

V_{DSS}	I_{D25}	$R_{DS(on)}$
500 V	44 A	0.12 Ω
500 V	48 A	0.10 Ω

$t_{rr} \leq 250$ ns

Symbol	Test Conditions	Maximum Ratings		
		IXFK	IXFN	
V_{DSS}	$T_J = 25^\circ\text{C}$ to 150°C	500	500	V
V_{DGR}	$T_J = 25^\circ\text{C}$ to 150°C ; $R_{GS} = 1$ M Ω	500	500	V
V_{GS}	Continuous	± 20	± 20	V
V_{GSM}	Transient	± 30	± 30	V
I_{D25}	$T_C = 25^\circ\text{C}$	44N50	44	A
		48N50	48	A
I_{DM}	$T_C = 25^\circ\text{C}$, pulse width limited by T_{JM}	44N50	176	A
		48N50	192	A
I_{AR}	$T_C = 25^\circ\text{C}$	24	24	A
E_{AR}	$T_C = 25^\circ\text{C}$	30	30	mJ
dv/dt	$I_S \leq I_{DM}$, $di/dt \leq 100$ A/ μs , $V_{DD} \leq V_{DSS}$, $T_J \leq 150^\circ\text{C}$, $R_G = 2$ Ω	5	5	V/ns
P_D	$T_C = 25^\circ\text{C}$	500	520	W
T_J		-55 ... +150		$^\circ\text{C}$
T_{JM}			150	$^\circ\text{C}$
T_{stg}		-55 ... +150		$^\circ\text{C}$
T_L	1.6 mm (0.063 in) from case for 10 s	300	-	$^\circ\text{C}$
V_{ISOL}	50/60 Hz, RMS $t = 1$ min	-	2500	V~
	$I_{ISOL} \leq 1$ mA $t = 1$ s	-	3000	V~
M_d	Mounting torque	0.9/6	1.5/13	Nm/lb.in.
	Terminal connection torque	-	1.5/13	Nm/lb.in.
Weight		10	30	g

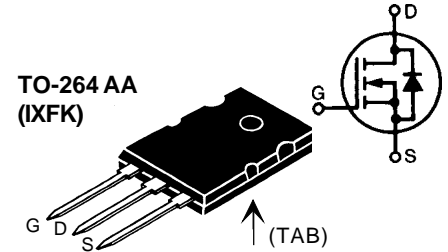

miniBLOC, SOT-227 B (IXFN)

E153432

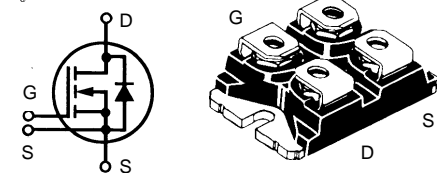

G = Gate
S = Source

D = Drain
TAB = Drain

Either Source terminal at miniBLOC can be used as Main or Kelvin Source

Features

- International standard packages
- Molding epoxies meet UL 94 V-0 flammability classification
- SOT-227B miniBLOC with aluminium nitride isolation
- Low $R_{DS(on)}$ HDMOS™ process
- Unclamped Inductive Switching (UIS) rated
- Fast intrinsic rectifier

Applications

- DC-DC converters
- Synchronous rectification
- Battery chargers
- Switched-mode and resonant-mode power supplies
- DC choppers
- Temperature and lighting controls

Advantages

- Easy to mount
- Space savings
- High power density

Symbol	Test Conditions	Characteristic Values ($T_J = 25^\circ\text{C}$, unless otherwise specified)		
		min.	typ.	max.
V_{DSS}	$V_{GS} = 0$ V, $I_D = 1$ mA	500		V
$V_{GS(th)}$	$V_{DS} = V_{GS}$, $I_D = 8$ mA	2		4 V
I_{GSS}	$V_{GS} = \pm 20$ V _{DC} , $V_{DS} = 0$			± 200 nA
I_{DSS}	$V_{DS} = 0.8 \cdot V_{DSS}$ $V_{GS} = 0$ V	$T_J = 25^\circ\text{C}$		400 μA
		$T_J = 125^\circ\text{C}$		2 mA
$R_{DS(on)}$	$V_{GS} = 10$ V, $I_D = 0.5 \cdot I_{D25}$ Pulse test, $t \leq 300$ μs , duty cycle $d \leq 2$ %	44N50		0.12 Ω
		48N50		0.10 Ω

Symbol	Test Conditions	Characteristic Values		
		(T _J = 25°C, unless otherwise specified)		
		min.	typ.	max.
g_{fs}	V _{DS} = 10 V; I _D = 0.5 • I _{D25} , pulse test	22	42	S
C_{iss} C_{oss} C_{rss}	V _{GS} = 0 V, V _{DS} = 25 V, f = 1 MHz		8400	pF
			900	pF
			280	pF
t_{d(on)} t_r t_{d(off)} t_f	V _{GS} = 10 V, V _{DS} = 0.5 • V _{DSS} , I _D = 0.5 • I _{D25} R _G = 1 Ω (External),		30	ns
			60	ns
			100	ns
			30	ns
Q_{g(on)} Q_{gs} Q_{gd}	V _{GS} = 10 V, V _{DS} = 0.5 • V _{DSS} , I _D = 0.5 • I _{D25}		270	nC
			60	nC
			135	nC
R_{thJC} R_{thCK}	TO-264 AA	0.15	0.25	K/W
	TO-264 AA			K/W
R_{thJC} R_{thCK}	miniBLOC, SOT-227 B	0.05	0.24	K/W
	miniBLOC, SOT-227 B			K/W

Source-Drain Diode

Symbol	Test Conditions	Characteristic Values		
		(T _J = 25°C, unless otherwise specified)		
		min.	typ.	max.
I_S	V _{GS} = 0 V			48 A
I_{SM}	Repetitive; pulse width limited by T _{JM}			192 A
V_{SD}	I _F = 100 A, V _{GS} = 0 V, Pulse test, t ≤ 300 μs, duty cycle d ≤ 2 %			1.5 V
t_{rr} Q_{RM} I_{RM}	I _F = I _S , -di/dt = 100 A/μs, V _R = 100 V		2	250 ns
			20	μC

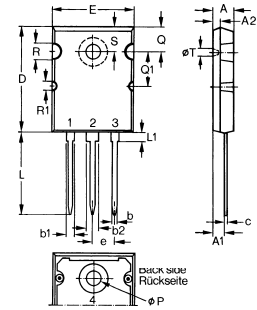
TO-264 AA Outline

Dim.	Millimeter		Inches	
	Min.	Max.	Min.	Max.
A	4.82	5.13	.190	.202
A1	2.54	2.89	.100	.114
A2	2.00	2.10	.079	.083
b	1.12	1.42	.044	.056
b1	2.39	2.69	.094	.106
b2	2.90	3.09	.114	.122
c	0.53	0.83	.021	.033
D	25.91	26.16	1.020	1.030
E	19.81	19.96	.780	.786
e	5.46 BSC		.215 BSC	
J	0.00	0.25	.000	.010
K	0.00	0.25	.000	.010
L	20.32	20.83	.800	.820
L1	2.29	2.59	.090	.102
P	3.17	3.66	.125	.144
Q	6.07	6.27	.239	.247
Q1	8.38	8.69	.330	.342
R	3.81	4.32	.150	.170
R1	1.78	2.29	.070	.090
S	6.04	6.30	.238	.248
T	1.57	1.83	.062	.072

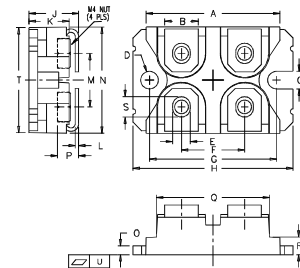
miniBLOC, SOT-227 B

M4 screws (4x) supplied

Dim.	Millimeter		Inches	
	Min.	Max.	Min.	Max.
A	31.50	31.88	1.240	1.255
B	7.80	8.20	0.307	0.323
C	4.09	4.29	0.161	0.169
D	4.09	4.29	0.161	0.169
E	4.09	4.29	0.161	0.169
F	14.91	15.11	0.587	0.595
G	30.12	30.30	1.186	1.193
H	38.00	38.23	1.496	1.505
J	11.68	12.22	0.460	0.481
K	8.92	9.60	0.351	0.378
L	0.76	0.84	0.030	0.033
M	12.60	12.85	0.496	0.506
N	25.15	25.42	0.990	1.001
O	1.98	2.13	0.078	0.084
P	4.95	5.97	0.195	0.235
Q	26.54	26.90	1.045	1.059
R	3.94	4.42	0.155	0.174
S	4.72	4.85	0.186	0.191
T	24.59	25.07	0.968	0.987
U	-0.05	0.1	-0.002	0.004

IXYS reserves the right to change limits, test conditions, and dimensions.

 IXYS MOSFETS and IGBTs are covered by one or more of the following U.S. patents: 4,835,592 4,881,106 5,017,508 5,049,961 5,187,117 5,486,715
 4,850,072 4,931,844 5,034,796 5,063,307 5,237,481 5,381,025