

# 0.39" Single Digit Alpha Numeric Display

## FEATURES

- 0.39" digit height
- Right hand decimal point
- Additional colors/materials available

## OPTO-ELECTRICAL CHARACTERISTICS (Ta = 25°C)

PART NO.	PEAK WAVE LENGTH (nm)	EMITTED COLOR	FACE COLORS		MAXIMUM RATINGS			OPTO-ELECTRICAL CHARACTERISTICS						PIN-OUT	
			SURFACE COLOR	EPOXY COLOR	IF (mA)	VR (V)	PD (mW)	VF(V)			IR(μA)		IV(μcd)		
								typ.	max.	@mA	max.	@VR	typ. per seg.		@mA
MTAN2139-AG	567	Green	Grey	White	30	5	85	2.1	3.0	20	100	5	2900	10	1
MTAN4139-AO	635	Orange	Grey	White	30	5	85	2.1	3.0	20	100	5	3300	10	1
MTAN4139-AHR	635	Hi-Eff Red	Red	Red	30	5	85	2.1	3.0	20	100	5	3300	10	1
MTAN7139M-11A	660	Ultra Red	Grey	White	30	4	70	1.7	2.2	20	100	4	17300	20	1
MTAN2139-CG	567	Green	Grey	White	30	5	85	2.1	3.0	20	100	5	2900	10	2
MTAN4139-CO	635	Orange	Grey	White	30	5	85	2.1	3.0	20	100	5	3300	10	2
MTAN4139-CHR	635	Hi-Eff Red	Red	Red	30	5	85	2.1	3.0	20	100	5	3300	10	2
MTAN7139M-11C	660	Ultra Red	Grey	White	30	4	70	1.7	2.2	20	100	4	17300	20	2

Operating Temperature: -25~+85, Storage Temperature: -25~+100. Other face/epoxy colors are available.

## PACKAGE DIMENSIONS AND PIN FUNCTIONS

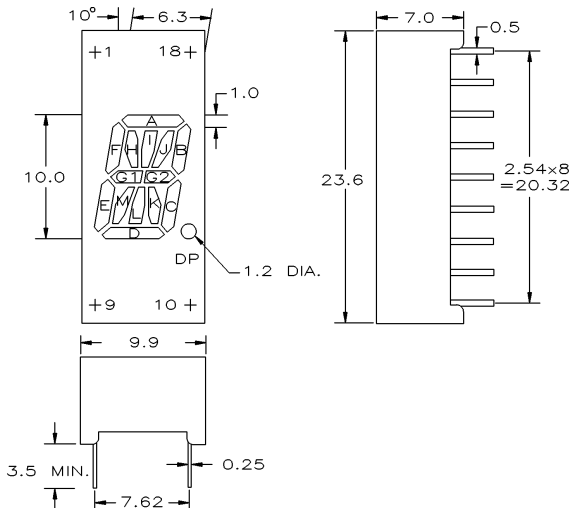

### PINOUT 1

COMMON ANODE

PIN NO. FUNCTION

1. CATHODE I
2. CATHODE H
3. CATHODE F
4. COMMON ANODE
5. CATHODE G1
6. CATHODE E
7. CATHODE M
8. CATHODE D
9. CATHODE L
10. CATHODE K
11. CATHODE C
12. CATHODE DP
13. COMMON ANODE
14. CATHODE G2
15. CATHODE B
16. CATHODE J
17. COMMON ANODE
18. CATHODE A

### PINOUT 2

COMMON CATHODE

PIN NO. FUNCTION

1. ANODE I
2. ANODE H
3. ANODE F
4. COMMON CATHODE
5. ANODE G1
6. ANODE E
7. ANODE M
8. ANODE D
9. ANODE L
10. ANODE K
11. ANODE C
12. ANODE DP
13. COMMON CATHODE
14. ANODE G2
15. ANODE B
16. ANODE J
17. COMMON CATHODE
18. ANODE A

1. ALL DIMENSIONS ARE IN mm. TOLERANCE IS ±0.25mm UNLESS OTHERWISE SPECIFIED.
2. THE SLOPE ANGLE OF ANY PIN MAY BE ±5.0° MAX.



120 Broadway • Menands, New York 12204

Toll Free: (800) 98-4LEDS • Fax: (518) 432-7454

For up-to-date product info visit our web site at [www.marktechopto.com](http://www.marktechopto.com)

All specifications subject to change.