

**DL-4038-021****High Power AlGaInP Laser Diode****Overview**

DL-4038-021 is a high power 635 nm (Typ.) AlGaInP laser diode with low threshold current. High output power and low threshold current are achieved by use of a strained quantum well active layer. The lasing wavelength is the same as that of the He-Ne gas lasers. DL-4038-021 is suitable for applications such as laser printers, line markers and other optical information systems.

**Features**

- Short wavelength : 635 nm (Typ.)
- High output power : 10mW CW
- Low threshold current :  $I_{th} = 35$  mA (Typ.)
- Low operating voltage :  $V_{op} = 2.2$  V (Typ.)

**Absolute Maximum Ratings at  $T_c=25^\circ\text{C}$** 

Parameter	Symbol	Ratings	Unit
Light Output	$P_o$	10	mW
Reverse Voltage	Laser PIN	$V_R$	2
			30
Operating Temperature	$T_{opr}$	-10 to +40	$^\circ\text{C}$
Storage Temperature	$T_{stg}$	-40 to +85	$^\circ\text{C}$

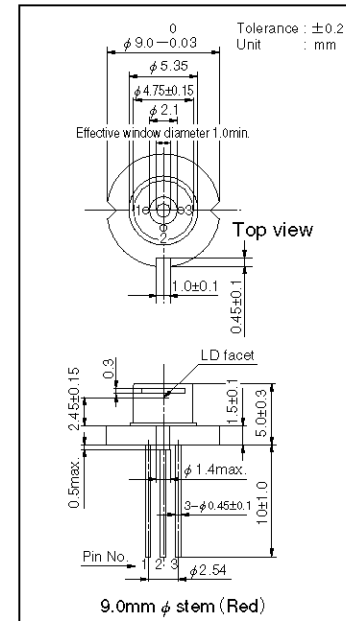
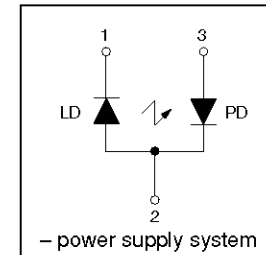
**Package Dimensions****Electrical Connection****Electrical and Optical Characteristics at  $T_c=25^\circ\text{C}$** 

Parameter	Symbol	Condition	Min.	Typ.	Max.	Unit
Threshold Current	$I_{th}$	CW	-	35	60	mA
Operating Current	$I_{op}$	$P_o=10\text{mW}$	-	55	80	mA
Operating Voltage	$V_{op}$	$P_o=10\text{mW}$	-	2.2	2.4	V
Lasing Wavelength	$\lambda_p$	$P_o=10\text{mW}$	-	635	645	nm
Beam Divergence ※)	Perpendicular	$\theta_{\perp}$	25	30	35	deg.
	Parallel	$\theta_{\parallel}$	6	8	10	deg.
Off Axis Angle	Perpendicular	$\Delta\theta_{\perp}$	-	-	$\pm 3$	deg.
	Parallel	$\Delta\theta_{\parallel}$	-	-	$\pm 3$	deg.
Differential Efficiency	$dP_o/dI_{op}$	-	-	0.5	-	mW/mA
Monitoring Output Current	$I_m$	$P_o=10\text{mW}$	0.05	0.15	0.4	mA
Astigmatism	$A_s$	$P_o=10\text{mW}$	-	8	-	$\mu\text{m}$

※) Full angle at half maximum note : The above product specifications are subject to change without notice.

**SANYO Electric Co., Ltd. Semiconductor Business Headquarters**

TOKYO OFFICE Tokyo Bldg., 1-10, 1 Chome, Ueno, Taito-ku, TOKYO, 110 JAPAN

N2897 GI, (IM) No.5857 1/3

## Characteristics

### Output power vs. Forward current

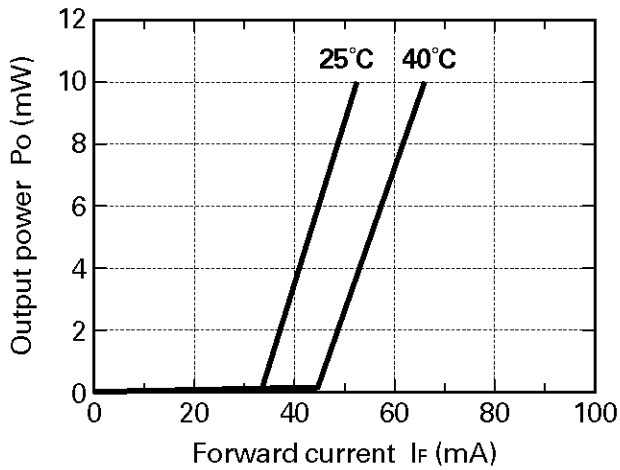

### Threshold current vs. Temperature

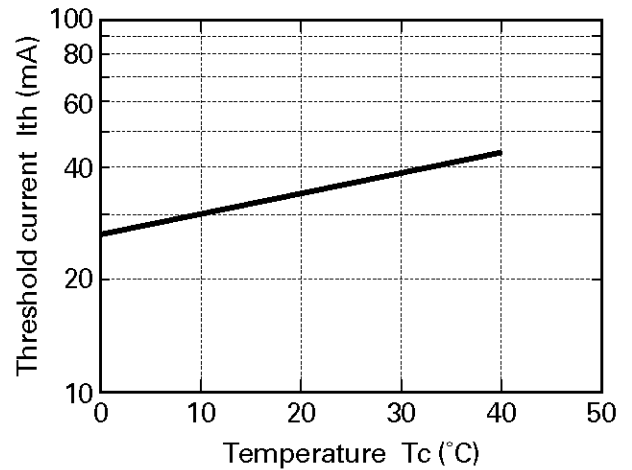

### Monitor current vs. Output power

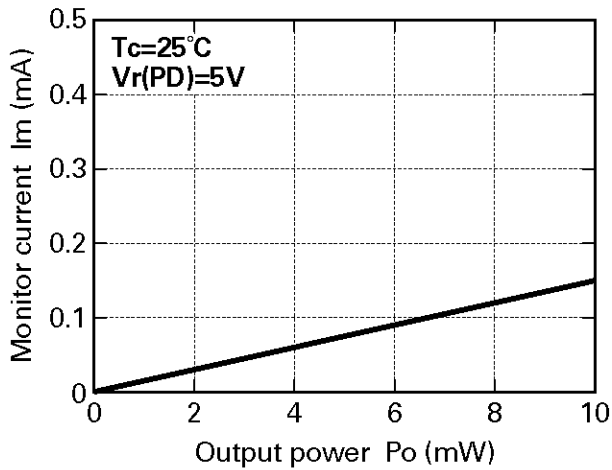

### Beam divergence

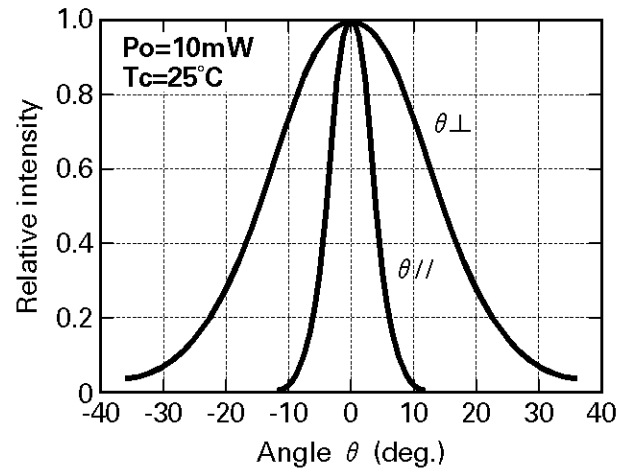

### Lasing wavelength vs. Temperature

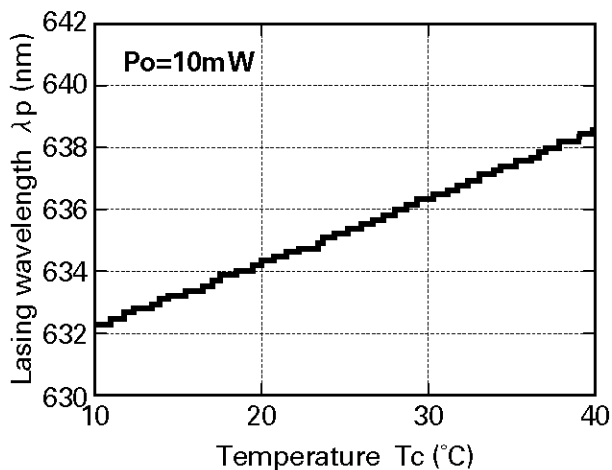

### Output power vs. Lasing wavelength

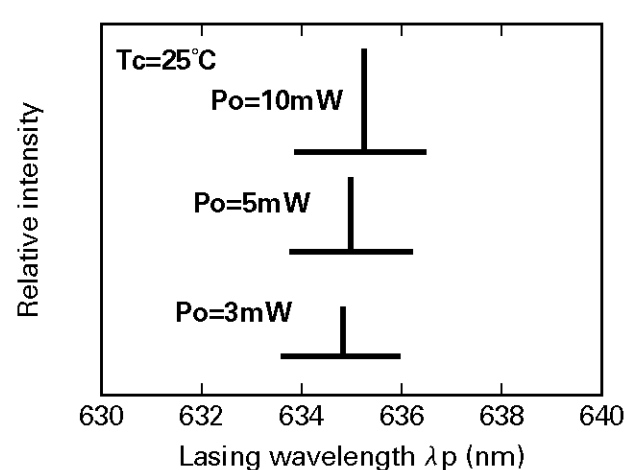

## CAUTION

1. No products described or contained herein are intended for use in surgical implants, life-support systems, aerospace equipment, nuclear power control systems, vehicles, disaster / crime-prevention equipment or the like, and the failure of which may directly or indirectly cause injury, death or property loss.
2. Anyone purchasing any products described or contained herein for an above-mentioned use shall:
  - 1) Accept full responsibility and indemnify and defend SANYO ELECTRIC CO.,LTD., it's affiliates, subsidiaries and distributors or any of their officers and employees, jointly and severally, against any and all claims and litigation and all damages, costs and expenses associated with such use.
  - 2) Not impose any responsibility for any fault or negligence which may be cited in any such claim or litigation on SANYO ELECTRIC CO., LTD., it's affiliates, subsidiaries and distributors or any of their officers and employees jointly or severally.
3. Information (including circuit diagrams and circuit parameters) disclosed herein is for example only; it is not guaranteed for mass production, SANYO believes the information disclosed herein is accurate and reliable, but no guarantees are made or implied regarding it's use or any infringements of intellectual property rights or other rights of third parties.

## Precautionary instructions in handling gallium arsenic products

Special precautions must be taken in handling this product because it contains, gallium arsenic, which is designated as a toxic substance by law. Be sure to adhere strictly to all applicable laws and regulations enacted for this substance, particularly when it comes to disposal.

Manufactured by ; **Tottori SANYO Electric Co., Ltd.**  
Electronics Device Bussiness Headquarters LED Division  
5-318, Tachikawa-cho, Tottori City, 680 Japan  
TEL: +81-857-21-2137 FAX: +81-857-21-2161