

Silicon NPN Epitaxial Planar Transistor (Complement to type 2SA1860)

Application : Audio and General Purpose

**Absolute maximum ratings** (Ta=25°C)

Symbol	2SC4886	Unit
Vcbo	150	V
Vceo	150	V
Vebo	5	V
Ic	14	A
Ib	3	A
Pc	80(Tc=25°C)	W
Tj	150	°C
Tstg	-55 to +150	°C

**Electrical Characteristics** (Ta=25°C)

Symbol	Conditions	2SC4886	Unit
Icbo	VcB=150V	100max	μA
IEBO	VEB=5V	100max	μA
V(BR)CEO	Ic=25mA	150min	V
hFE	VCE=4V, Ic=5A	50min*	
VCE(sat)	Ic=5A, Ib=500mA	2.0max	V
fr	VCE=12V, IE=-2A	60typ	MHz
COB	VcB=10V, f=1MHz	200typ	pF

\*hFE Rank O(50 to 100), P(70 to 140), Y(90 to 180)

**Typical Switching Characteristics (Common Emitter)**

Vcc (V)	RL (Ω)	Ic (A)	VBB1 (V)	VBB2 (V)	Ib1 (A)	Ib2 (A)	ton (μs)	tstg (μs)	tr (μs)
60	12	5	10	-5	0.5	-0.5	0.26typ	1.5typ	0.35typ

**External Dimensions FM100(TO3PF)**

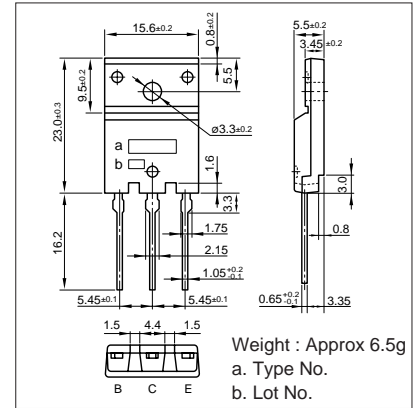

**Ic-VCE Characteristics (Typical)**

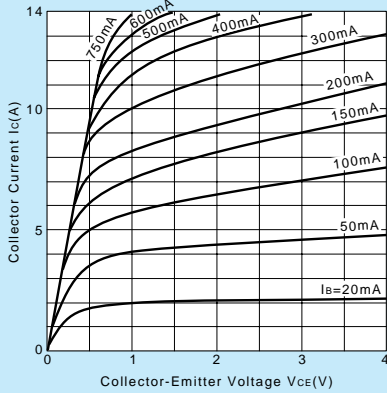

**VCE(sat)-Ib Characteristics (Typical)**

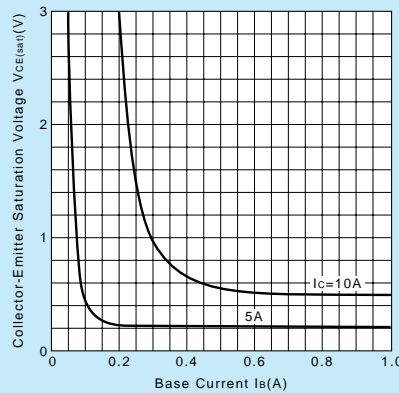

**Ic-VBE Temperature Characteristics (Typical)**

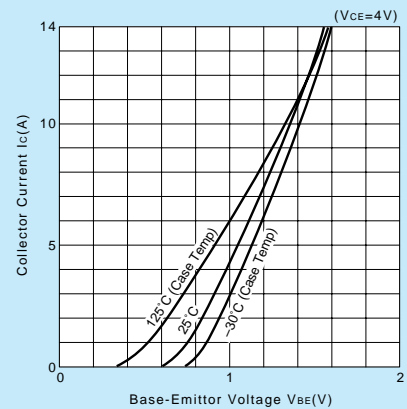

**hFE-Ic Characteristics (Typical)**

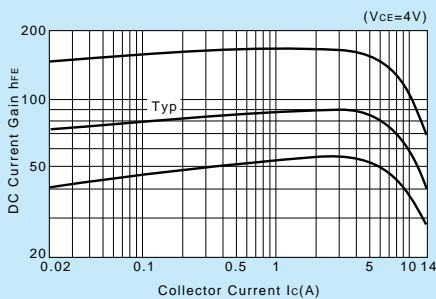

**hFE-Ic Temperature Characteristics (Typical)**

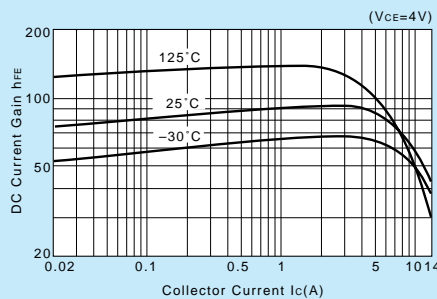

**θj-a-t Characteristics**

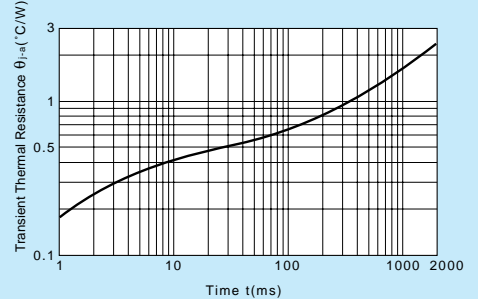

**fr-IE Characteristics (Typical)**

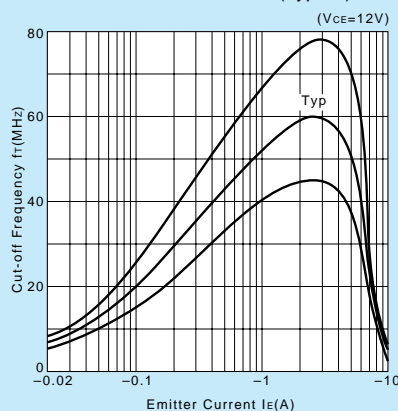

**Safe Operating Area (Single Pulse)**

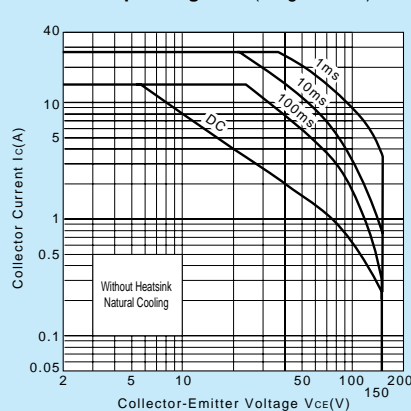

**Pc-Ta Derating**

